

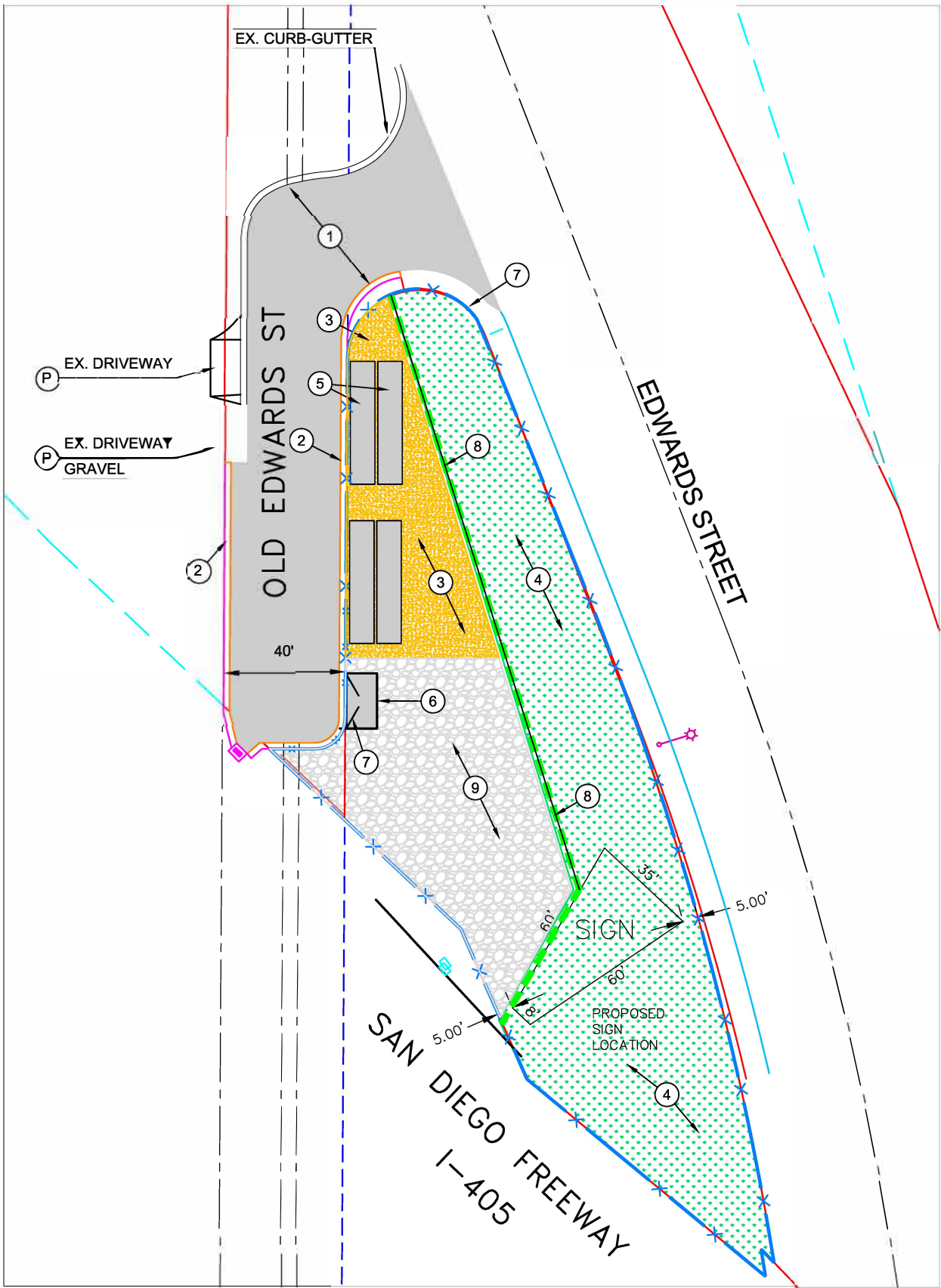





Attachment 3



CONSTRUCTION NOTES

- 1. COLD PLANE 2.5" OF EXISTING PAVEMENT AND CRACK FILL FULL STREET WIDTH, AND PLACE 2.5" CONVENTIONAL SURFACE COURSE.
- 2. REMOVE AND REPLACE EXISTING CURB & GUTTER PER CITY OF WESTMINSTER STD. DWG. 201, TYPE A-2-8" CURB FACE.
- 3. INSTALL NEW SIDEWALK PER CITY OF WESTMINSTER STD. DWG. 203.
- 4. EXISTING LANDSCAPE - PROTECT IN PLACE.
- 5. STORAGE CONTAINER.
- 6. CONSTRUCT NEW COMMERCIAL DRIVEWAY PER CITY OF WESTMINSTER STD. DWG. 209.
- 7. PROPOSED FENCE WITH DOUBLE SWING GATES.
- 8. CONSTRUCT RETAINING WALL.
- 9. CONSTRUCT NEW PARKING LOT.

LEGEND

-  STORAGE CONTAINERS
-  SIDEWALK
-  PARKING LOT
-  FENCE
-  RETAINING WALL

REVISION	DATE	REVISIONS	REFERENCES	APPROVALS



ENGINEERING SCALE: AS NOTED ON PLAN	DATE:
PREPARED UNDER THE SUPERVISION OF: JAKE QUAN NGO	
R.C.E. NO. C73699	
DRAWN: S. PITHWA	SEPT 2025
CHECKED:	SEPT 2025
RECOMMENDED:	SEPT 2025
APPROVED:	
PUBLIC WORKS DIRECTOR	

CITY OF WESTMINSTER
EDWARDS STREET MAINTENANCE FACILITY
City of Westminster - Engineering Dept.